

REMOVAL

1. INSPECT SHOE LINING THICKNESS

Remove the inspection hole plug, and check the shoe lining thickness through the hole.

If less than the minimum, replace the shoes.

Minimum thickness: 1.0 mm (0.039 in.)

2. REMOVE REAR WHEEL

Torque: 110 N·m (1,150 kgf·cm, 83 ft·lbf)

3. RELEASE PARKING BRAKE LEVER

4. REMOVE BRAKE DRUM

HINT:

If the brake drum cannot be removed easily, do the following steps.

- Remove the adjusting hole plug in the backing plate.
- Insert a screwdriver through the hole in the backing plate, and hold the automatic adjusting lever away from the adjusting bolt.
- Using the other screwdriver, reduce the brake shoe adjustment by turning the adjusting bolt.

5. REMOVE REAR SHOE

- Using SST, disconnect the return spring from the shoe.
SST 09703-30010
- Remove the return spring from the front shoe.

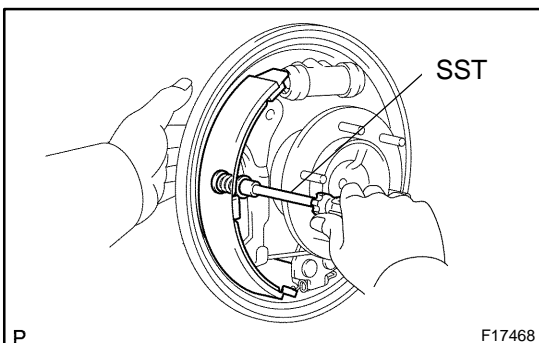
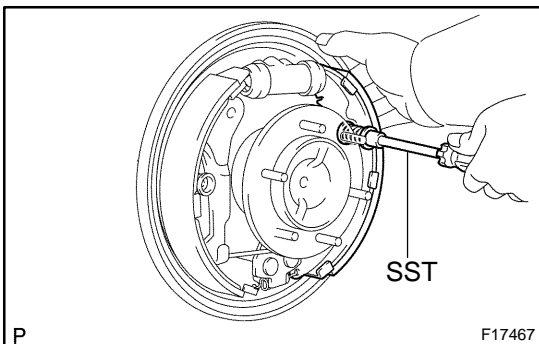
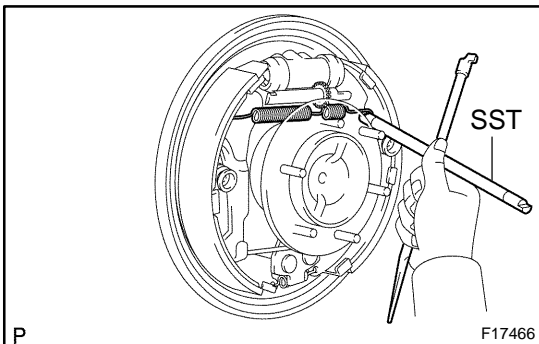
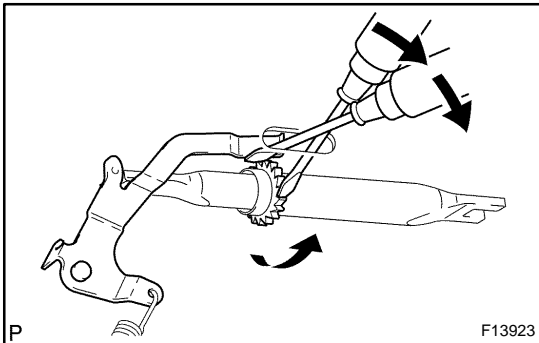

- Using SST, remove the shoe hold-down spring, cups and pin.
SST 09718-00010
- Remove the adjuster.
- Using needle-nose pliers, remove the adjusting lever spring.
- Remove the automatic adjusting lever.
- Disconnect the anchor spring from the rear shoe and remove the rear shoe.
- Remove the anchor spring from the front shoe.

6. REMOVE FRONT SHOE

- Using SST, remove the shoe hold-down spring, cups and pin.
SST 09718-00010
- Disconnect the parking brake cable from the front shoe.
- Remove the front shoe and parking brake cable.

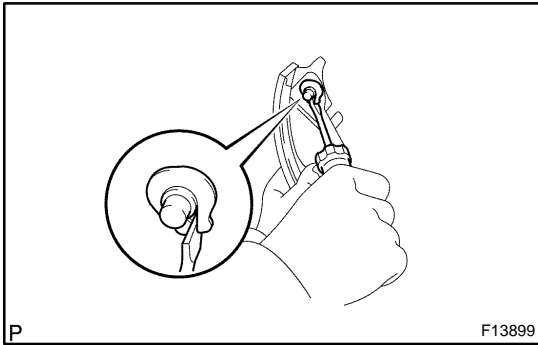
**7. REMOVE PARKING BRAKE LEVER**

- (a) Using a screwdriver, remove the C-washer.
- (b) Remove the parking brake lever.

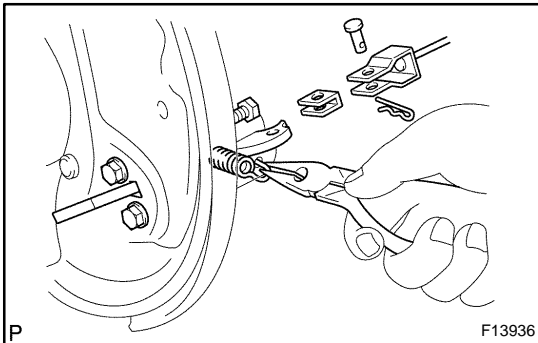
**8. REMOVE AND DISASSEMBLE PARKING BRAKE BELLCRANK**

- (a) Remove the clip and disconnect the parking brake cable.
- (b) Remove the 2 tension springs.
- (c) Remove the 2 bolts and bellcrank.
Torque: 13 N-m (130 kgf-cm, 9 ft-lbf)
- (d) Remove the bellcrank boot from the bellcrank bracket.

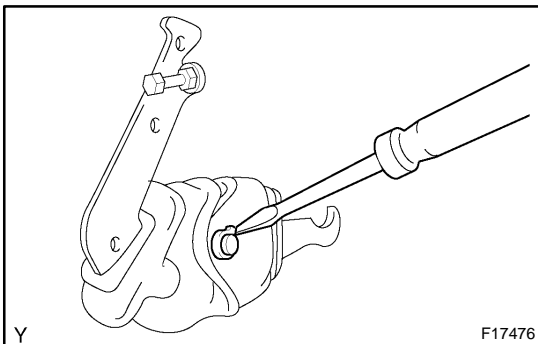

- (e) Using a screwdriver, remove the C-washer and pin.
- (f) Remove the parking brake bellcrank from the bellcrank bracket.

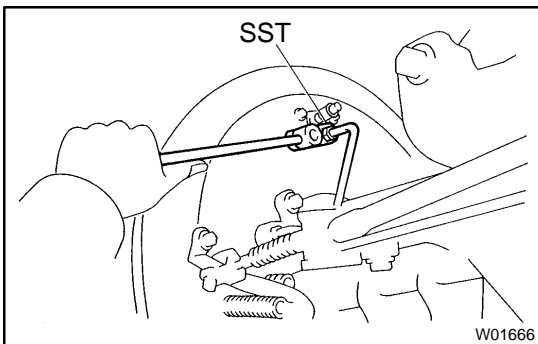
**9. REMOVE WHEEL CYLINDER**

- (a) Using SST, disconnect the brake line. Use a container to catch the brake fluid.

Torque: 15 N-m (155 kgf-cm, 11 ft-lbf)

SST 09023-00100

- (b) Remove the 2 bolts and the wheel cylinder.

Torque: 10 N-m (102 kgf-cm, 7.4 ft-lbf)

10. DISASSEMBLE WHEEL CYLINDER

- (a) Remove the 2 boots from the wheel cylinder.
- (b) Remove the 2 pistons and spring.
- (c) Remove the 2 cups from the each piston.