

CYLINDER HEAD COMPONENTS

EM1MX-02

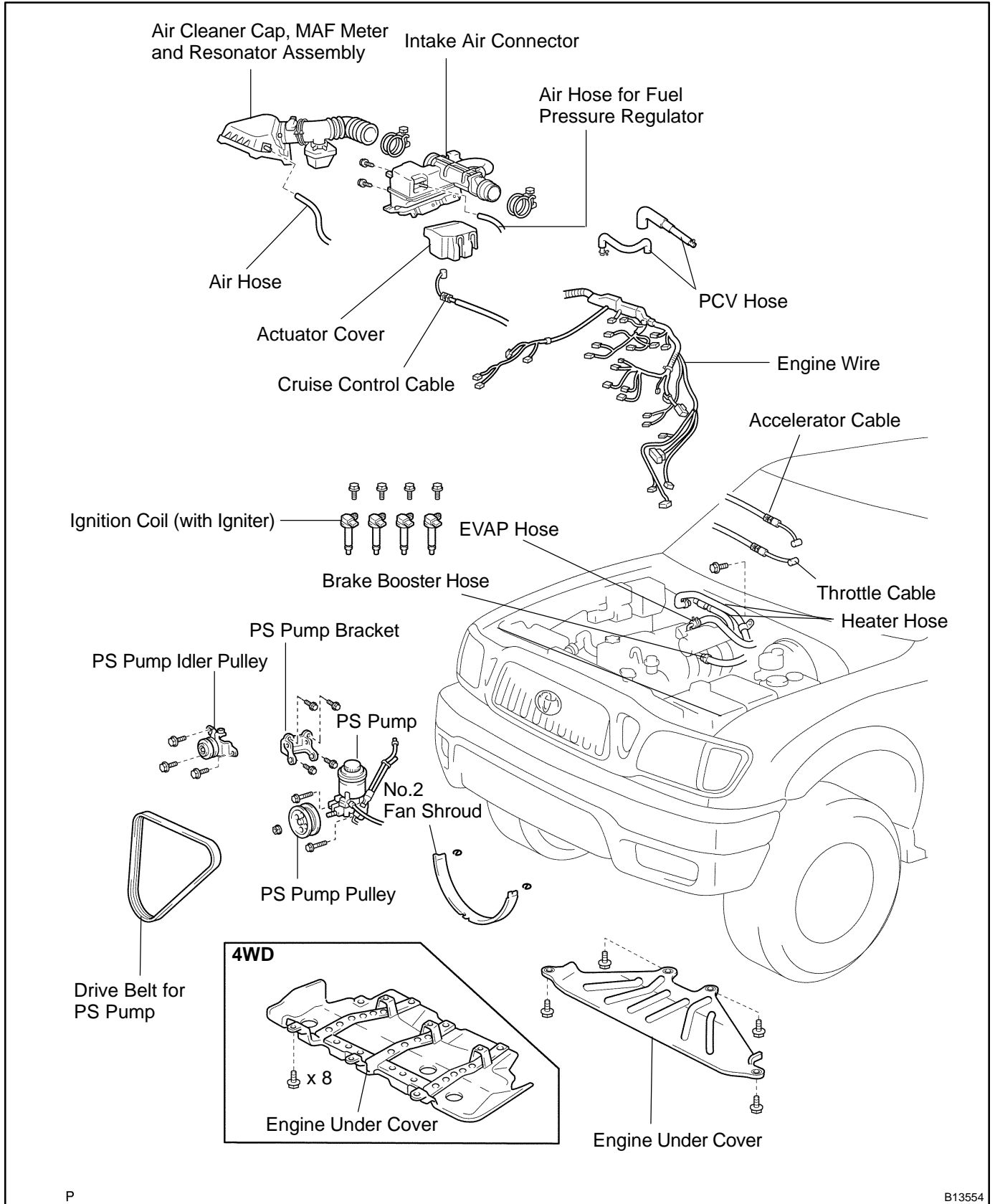

P

B13554

for 2RZ-FE

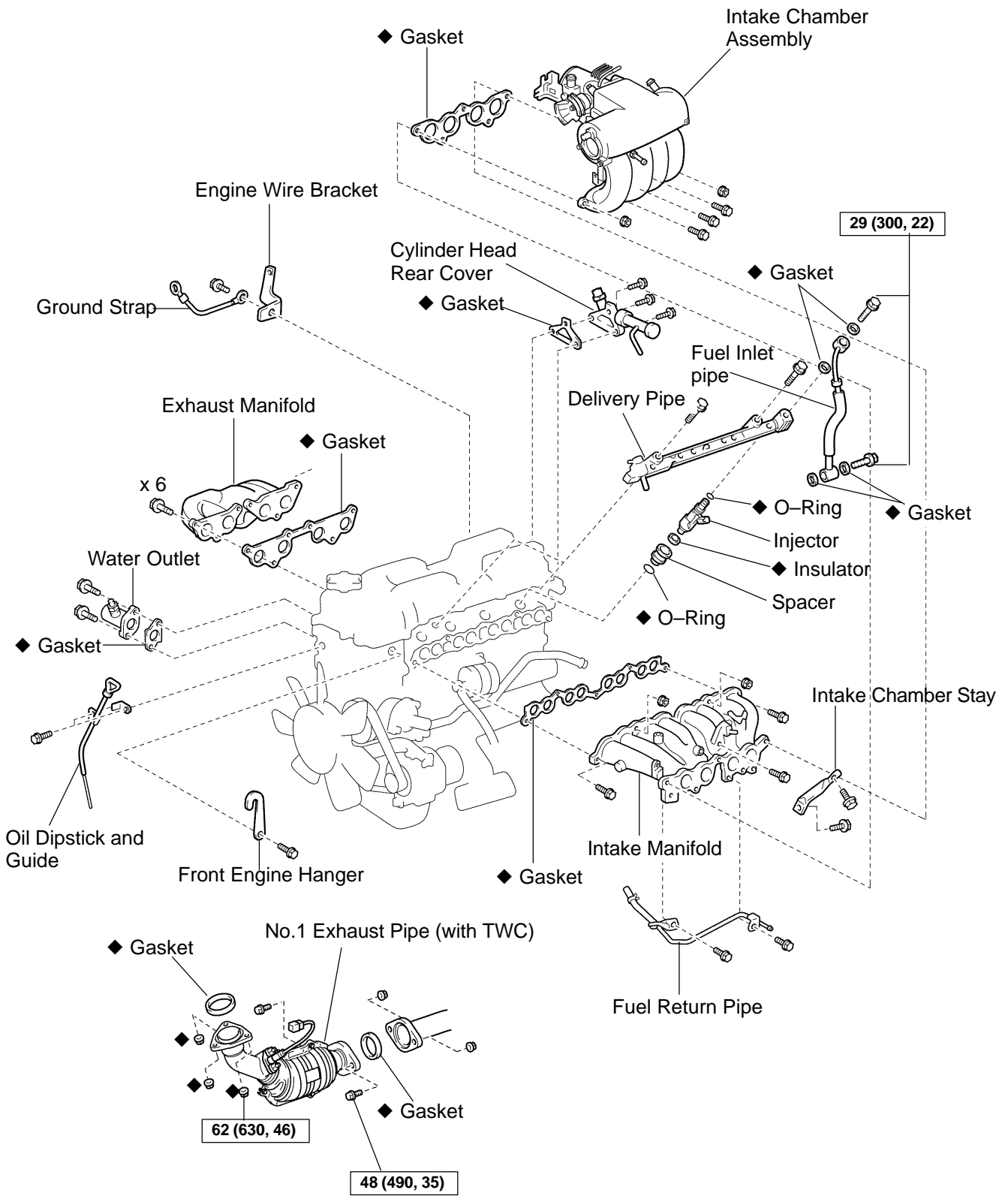

N·m (kgf·cm, ft·lbf) : Specified torque

◆ Non-reusable part

A17818

for 3RZ-FE

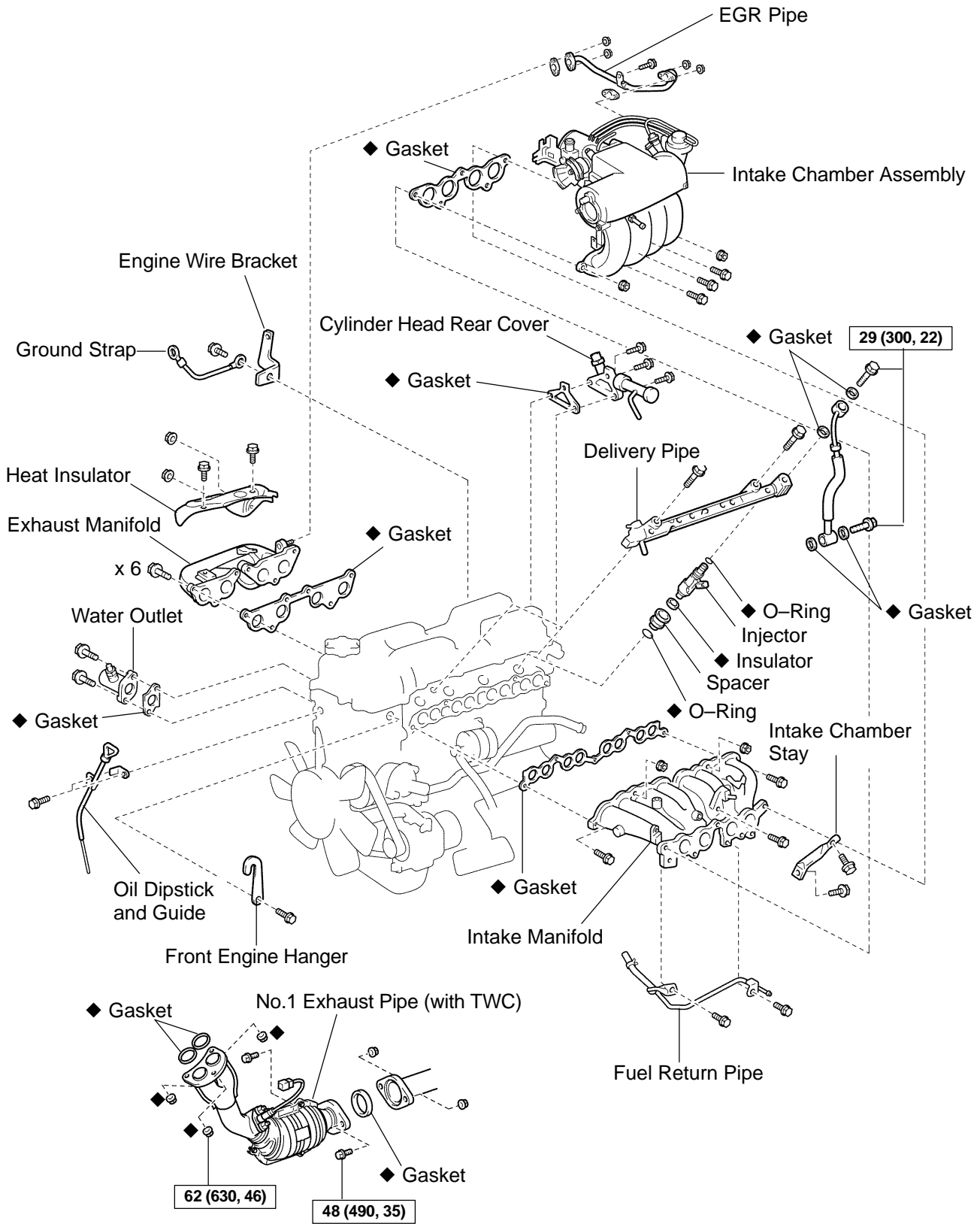

N·m (kgf·cm, ft·lbf) : Specified torque

◆ Non-reusable part

A17819

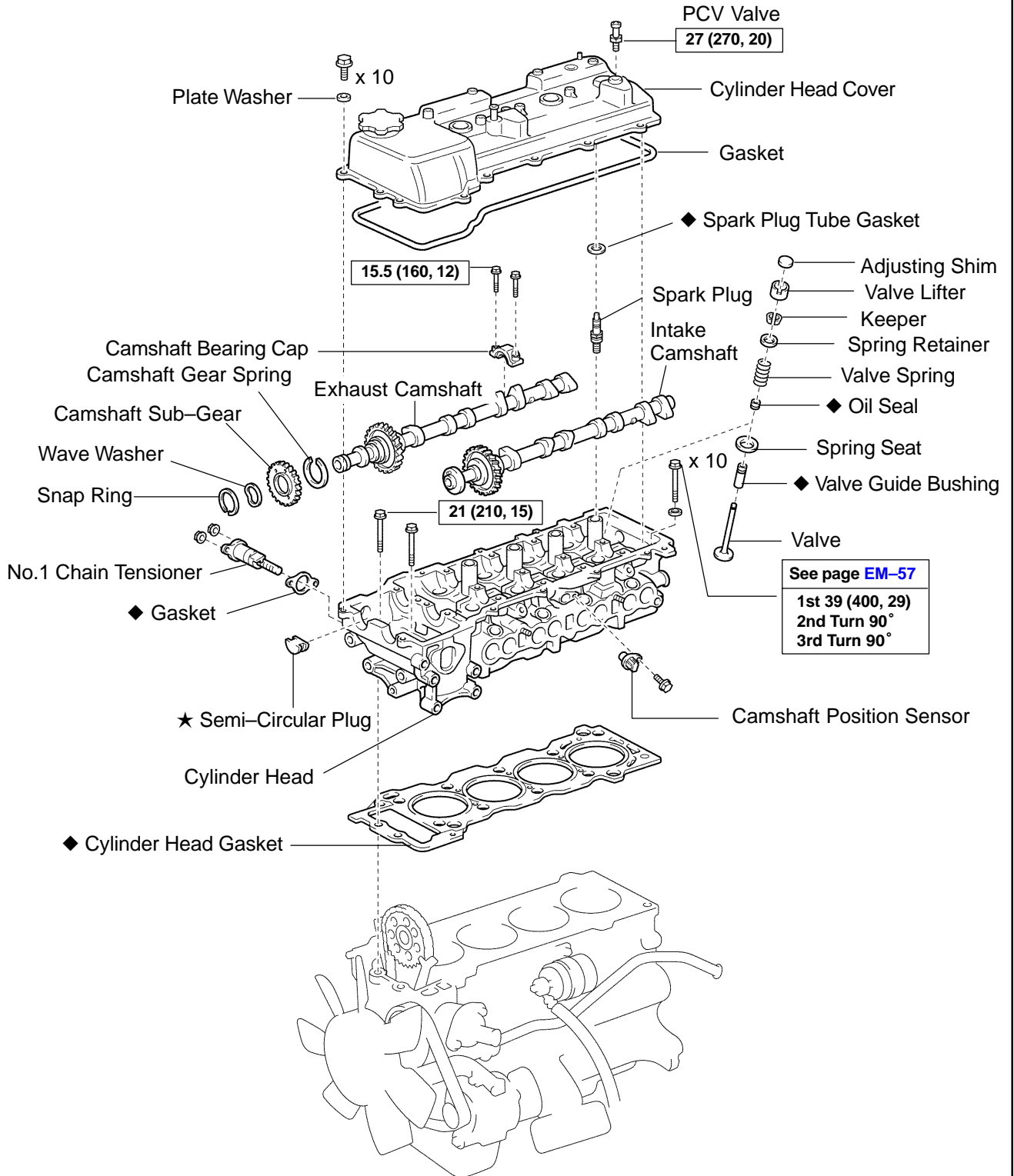

See page EM-57
 1st 39 (400, 29)
 2nd Turn 90°
 3rd Turn 90°

N·m (kgf·cm, ft·lbf) : Specified torque

◆ Non-reusable part

★ Precoated part

B13568