

DISASSEMBLY

NOTICE:

When using a vise, do not overtighten it.

1. REMOVE 2 TURN PRESSURE TUBES

- (a) Using SST, remove the 2 turn pressure tubes.
SST 09023-38200
- (b) Remove the 4 O-rings from the tubes.

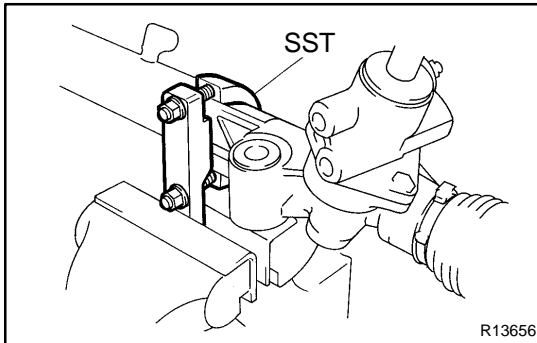

2. SECURE PS GEAR ASSEMBLY IN VISE

Using SST, secure the gear assembly in a vise.

SST 09612-00012

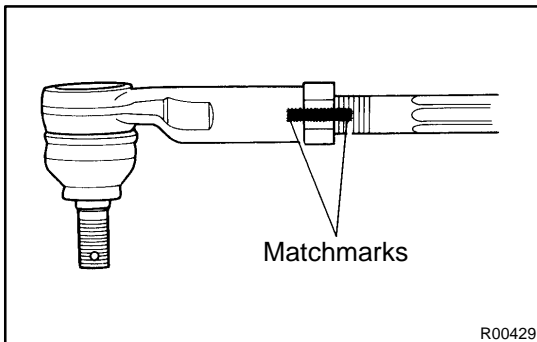

3. REMOVE RH AND LH TIE ROD ENDS AND LOCK NUTS

- (a) Place matchmarks on the tie rod end and rack end.
- (b) Loosen the lock nut, and remove the tie rod end and lock nut.
- (c) Employ the same manner described above to the other side.

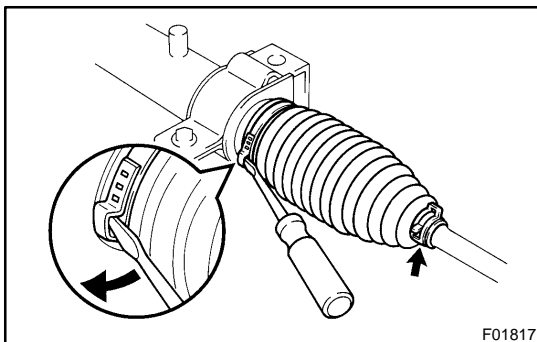

4. REMOVE RH AND LH CLIPS, RACK BOOTS AND CLAMPS

- (a) Using a screwdriver, loosen the clamp.

NOTICE:

Be careful not to damage the rack boot.

- (b) Remove the clip and rack boot.
- (c) Employ the same manner described above to the other side.

HINT:

Mark the RH and LH rack boots.

5. REMOVE RH AND LH RACK ENDS AND CLAW WASHERS

- (a) Using a screwdriver and hammer, unstake the washer.

NOTICE:

Avoid any impact to the steering rack.

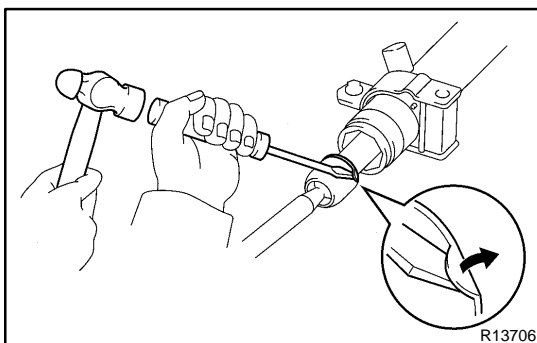

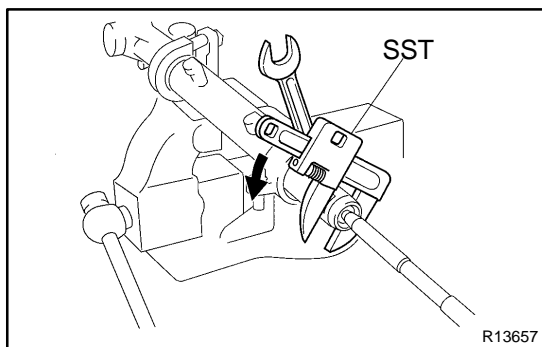

- (b) Using a spanner to hold the steering rack steady, and using SST, remove the rack end.
SST 09922-10010

NOTICE:

Use SST 09922-10010 in the direction shown in the illustration.

- (c) Remove the claw washer.
(d) Employ the same manner described above to the other side.

HINT:

Mark the RH and LH rack ends.

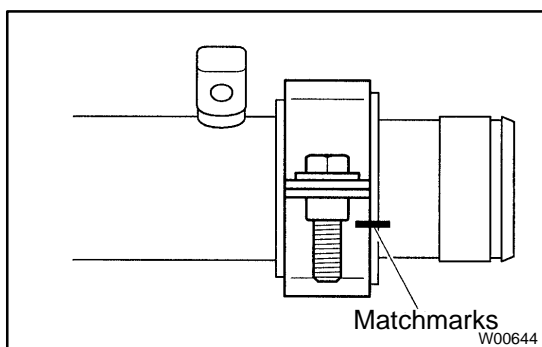
**6. REMOVE RACK HOUSING NO.2 BRACKET AND GROMMET**

- (a) Place matchmarks on the bracket and rack housing.
(b) Remove the bolt, rack housing No.2 bracket and grommet.

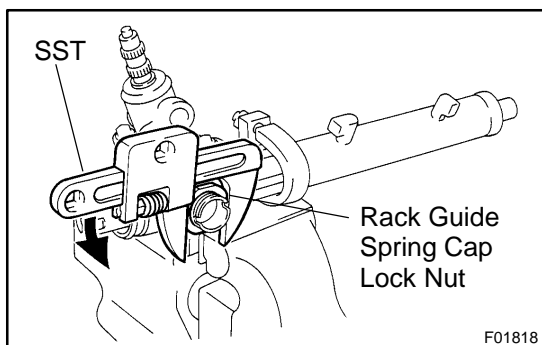
**7. REMOVE RACK GUIDE SPRING CAP LOCK NUT**

Using SST, remove the rack guide spring cap lock nut.
SST 09922-10010

NOTICE:

Use SST 09922-10010 in the direction shown in the illustration.

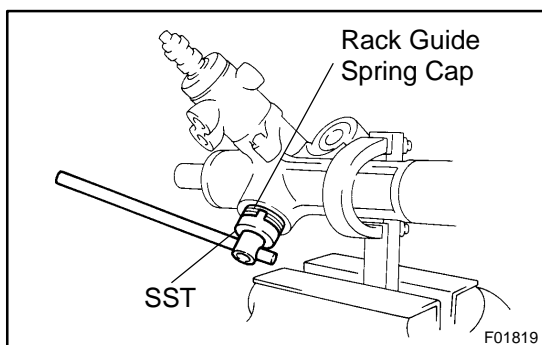
**8. REMOVE RACK GUIDE SPRING CAP, RACK GUIDE SPRING, RACK GUIDE AND RACK GUIDE SEAT**

- (a) Using SST, remove the rack guide spring cap, rack guide spring and rack guide.
SST 09631-10021
(b) Remove the rack guide seat from the guide.

9. REMOVE RACK HOUSING CAP

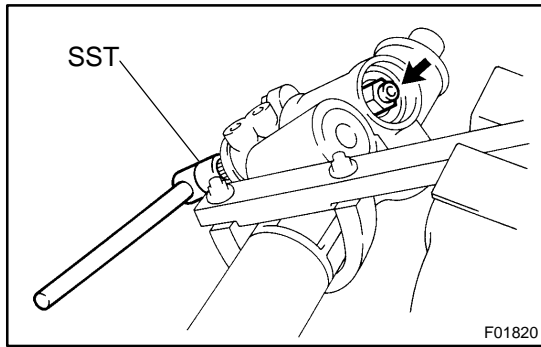

10. REMOVE SELF-LOCKING NUT

Using SST to stop the control valve shaft rotating, remove the self locking nut.

SST 09616-00011

11. REMOVE DUST COVER

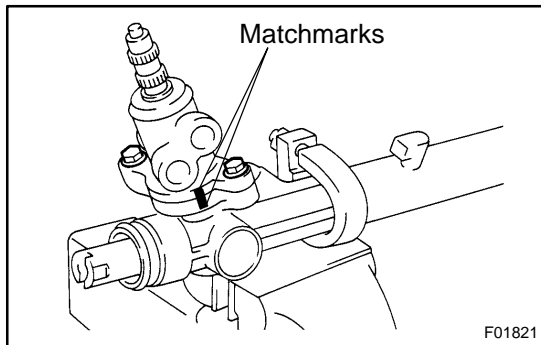

12. REMOVE CONTROL VALVE HOUSING WITH CONTROL VALVE ASSEMBLY

- (a) Place matchmarks on the control valve housing and rack housing.
- (b) Remove the 2 bolts.
- (c) Pull out the control valve housing with the control valve assembly.
- (d) Remove the gasket from the rack housing.

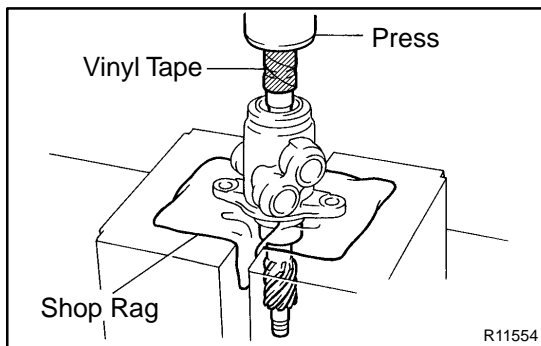

13. REMOVE CONTROL VALVE ASSEMBLY

- (a) To prevent oil seal lip damage, wind vinyl tape on the serrated part of the valve shaft.
- (b) Press out the control valve assembly with the oil seal.

NOTICE:

- Place a shop rag between the valve housing and the blocks.
- Be careful not to drop the valve assembly.
- Be careful not to damage the oil seal lip.

14. REMOVE OIL SEAL

Remove the oil seal from the control valve assembly.

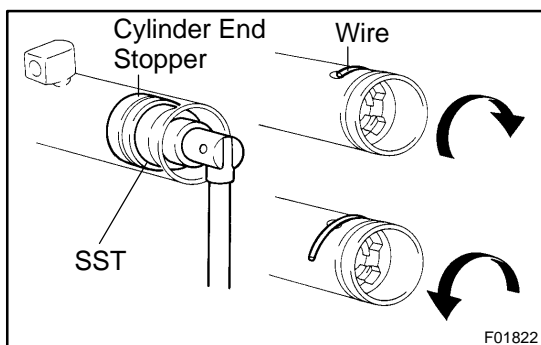

15. REMOVE CYLINDER END STOPPER

- (a) Using SST, turn the cylinder end stopper clockwise until the wire end is visible through the service hole.

SST 09631-10021

- (b) Using SST, turn the cylinder end stopper counterclockwise, and remove the wire and cylinder end stopper.

SST 09631-10021

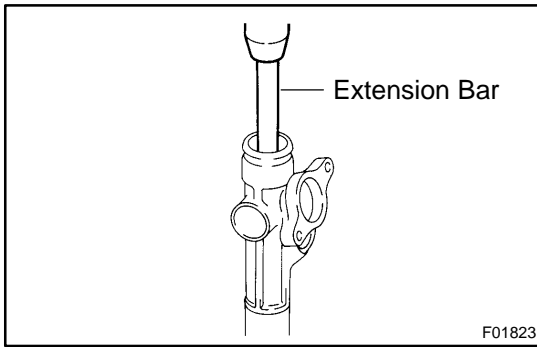
**16. REMOVE STEERING RACK AND BUSHING**

- (a) Using an extension bar and socket wrench (19 mm), press out the rack with the bushing.

NOTICE:

Take care not to drop the rack.

- (b) Remove the bushing from the rack.
 (c) Remove the O-ring from the bushing.

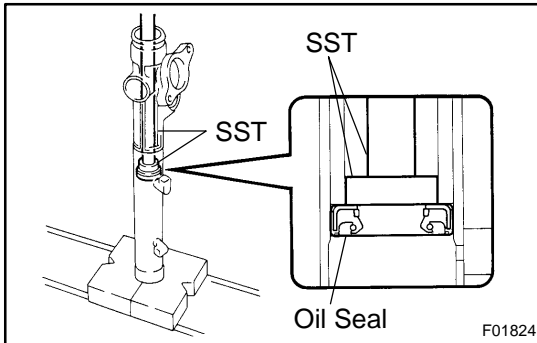
**17. REMOVE OIL SEAL**

Using SST, press out the oil seal.

- SST 09950-60010 (09951-00280),
 09950-70010 (09951-07360)